

# WELCOME TO THE PAVILION

The Pavilion is a stunning contemporary venue, offering a spacious, light-filled environment, thanks to its expansive windows. The building's design is complemented by a roofed veranda, with green steps leading down to a beautiful lawn that overlooks the main ring.

This versatile space is perfect for all types of events, whether you're planning a corporate meeting, conference, exhibition, award dinner, or something entirely unique.



# ROOMS AND CAPACITIES

The Pavilion is a luminous white canvas full of possibilities, the main room is formed by two event spaces, which can also be combined or used in conjunction with each other, creating an endless number of possible layouts for your event.

Our events team would be happy to discuss the various setup options available to you, including boardroom, banquet, and conference layouts.

The venue also has a fully equipped bar that could be used during the event (stocking to be discussed with the caterer).

|            | Full Suite | West Suite | East Suite |
|------------|------------|------------|------------|
| Theatre    | 400        | 250        | 100        |
| Classroom  | 190        | 128        | 60         |
| Boardroom  | -          | 3x30       | 30         |
| Banquet    | 300        | 200        | 100        |
| Cabaret    | 200        | 160        | 60         |
| Reception  | 450        | 400        | 100        |
| Floor Area | 520.2 m2   | 375 m2     | 142.5 m2   |

# EXCLUSIVE USE

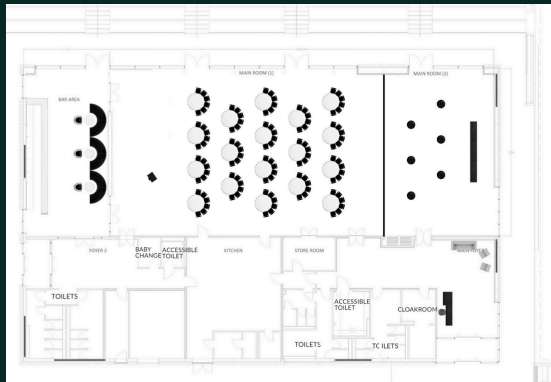
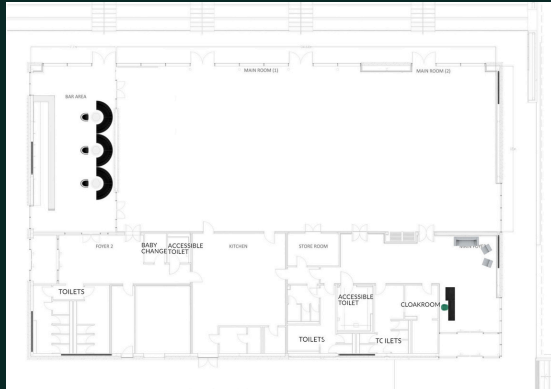

# WEST SUITE

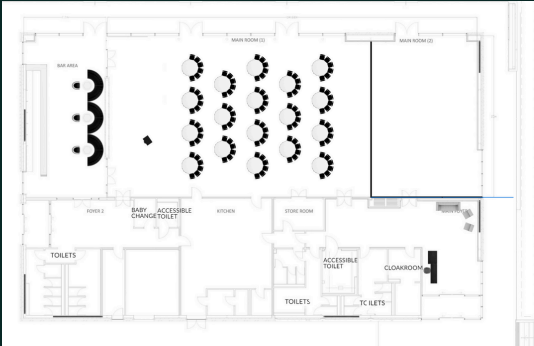

# EAST SUITE

